

ASSEMBLY INSTRUCTION
RYEDALE Electric Lift Desk
ITEM CODE 85155

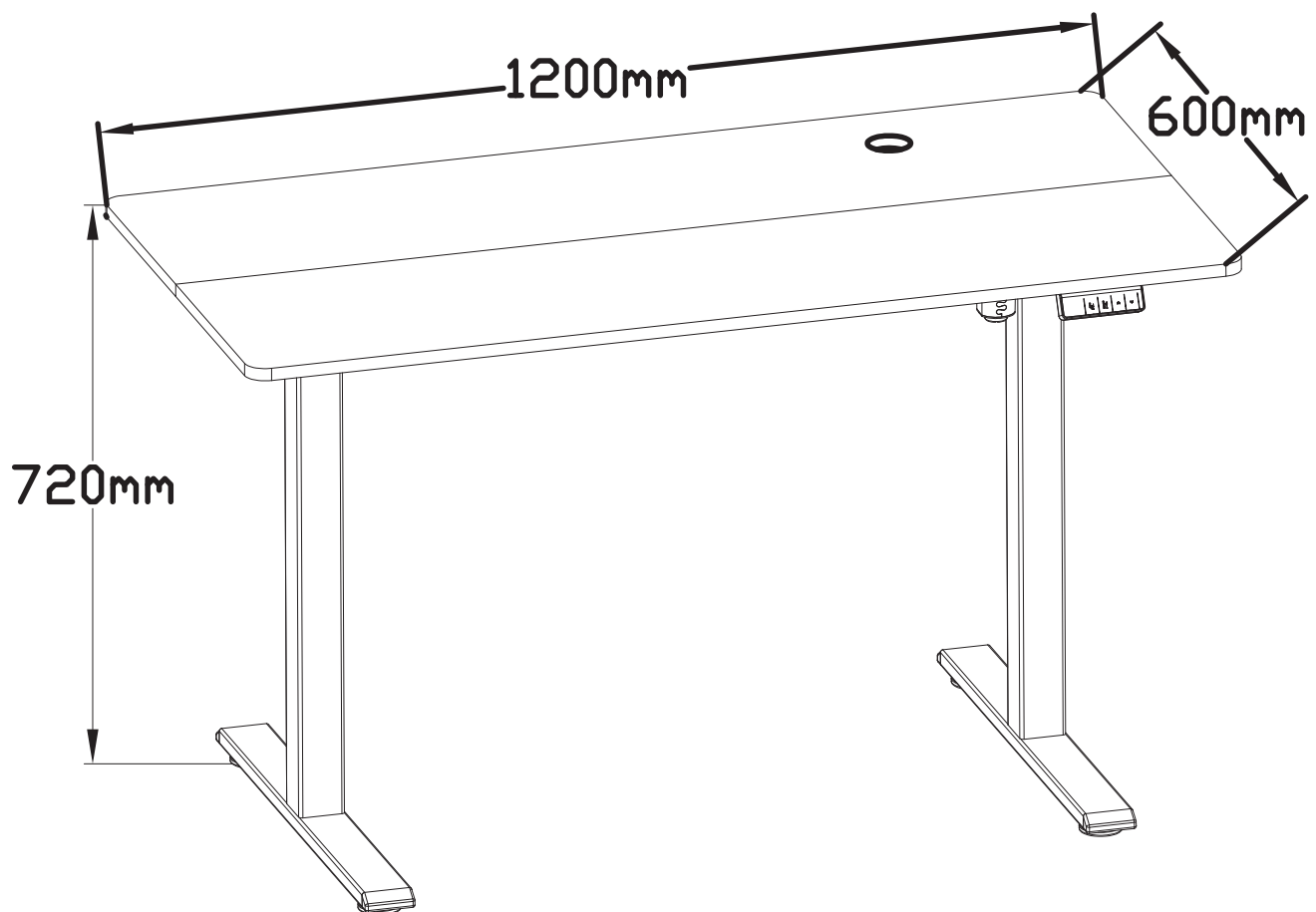

Imported by JWA Furniture Pty Ltd, Qld, Brisbane Australia.
For any assistance with assembly or for missing parts please refer to your receipt

PRE-ASSEMBLY PREPARATION

Before you start:

1. Choose a clean level, spacious assembly area. Avoid hard surfaces that may damage the product.
2. Take care when lifting. Product should be assembled as near as possible to the point of use.
3. Ensure that you have all required contents for complete assembly.
4. Always read the assembly instructions carefully before beginning assembly.
5. Keep all hardware parts and packaging out of reach of small children.
6. Do not over tighten the screws and bolts as this may damage the threads.



PARTS LIST

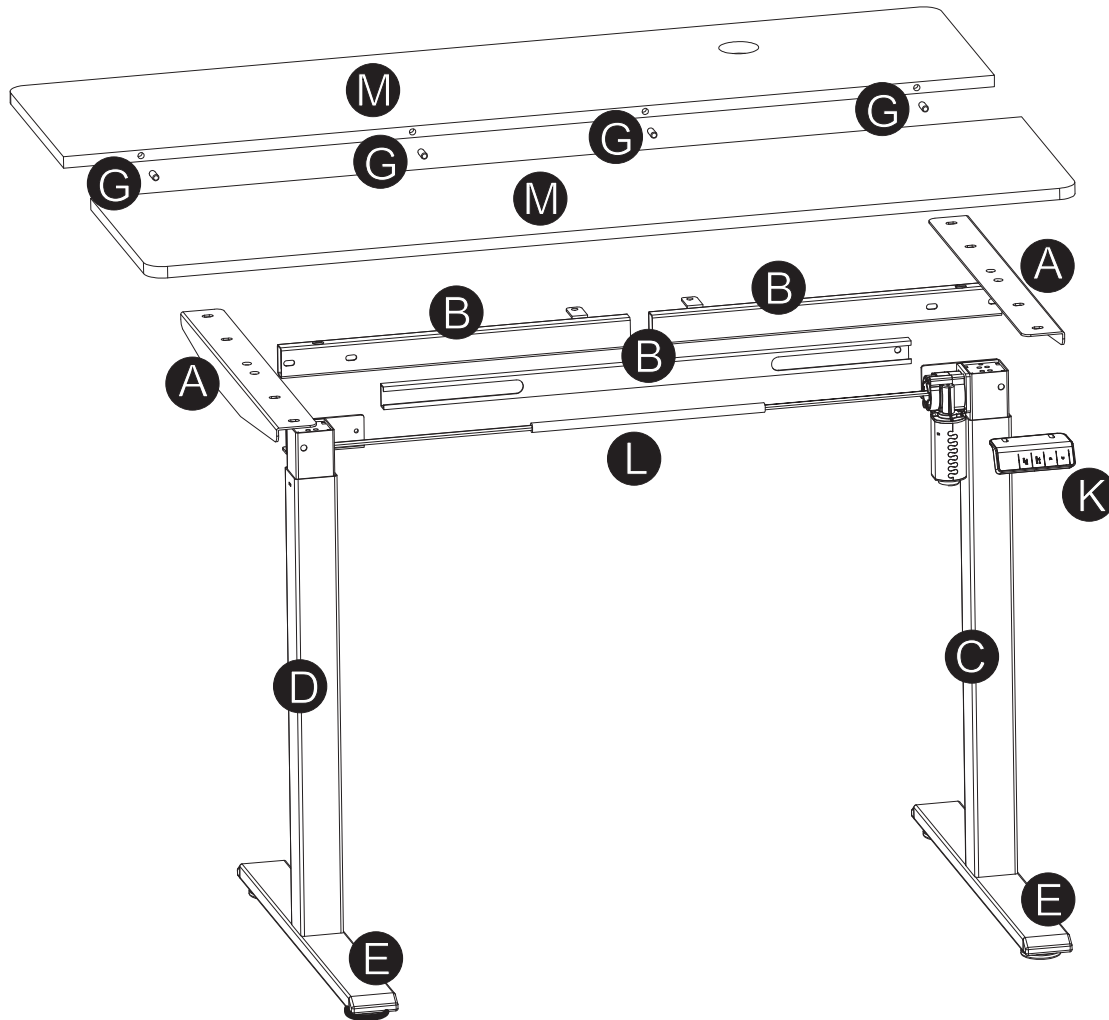

A*2pc

Length 500mm, thickness 2.0mm



B*1pc

Length 910mm-1300mm, thickness 1.5mm

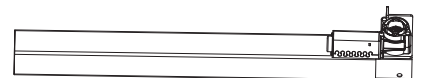

C*1pc

Outer tube 55 * 55mm, inner tube 50 * 50mm, thickness 1.5mm



D*1pc

Outer tube 55 * 55mm, inner tube 50 * 50mm, thickness 1.5mm

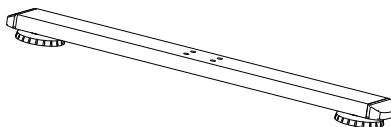

E*2pc

W600*D70*H20mm



F*4PC



G*4pc
φ0.8×6 CM

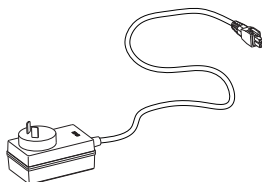

J*1pc
W207*D4*H5CM



K*1pc

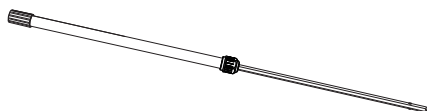

L*1pc

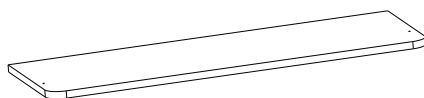

M*2pc
W120*D30*H1.5CM

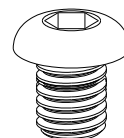

S-A*1PC
M6X6mm

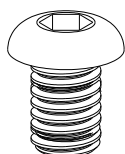

S-B*5PC(+1)
M6X8mm

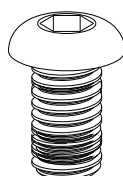

S-C*4PC(+1)
M6X12mm

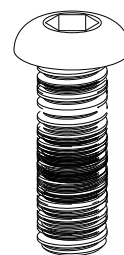

S-D*8PC(+1)
M6X30mm

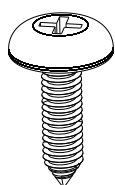

S-F*12PC(+1)
ST5.0X14mm

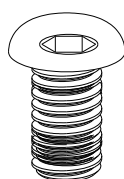

S-G*4PC(+1)
M6X10mm



S-E*1pc
4mm

STEP1: Attaching the Crossbar

Caution: Welding plate facing upwards.

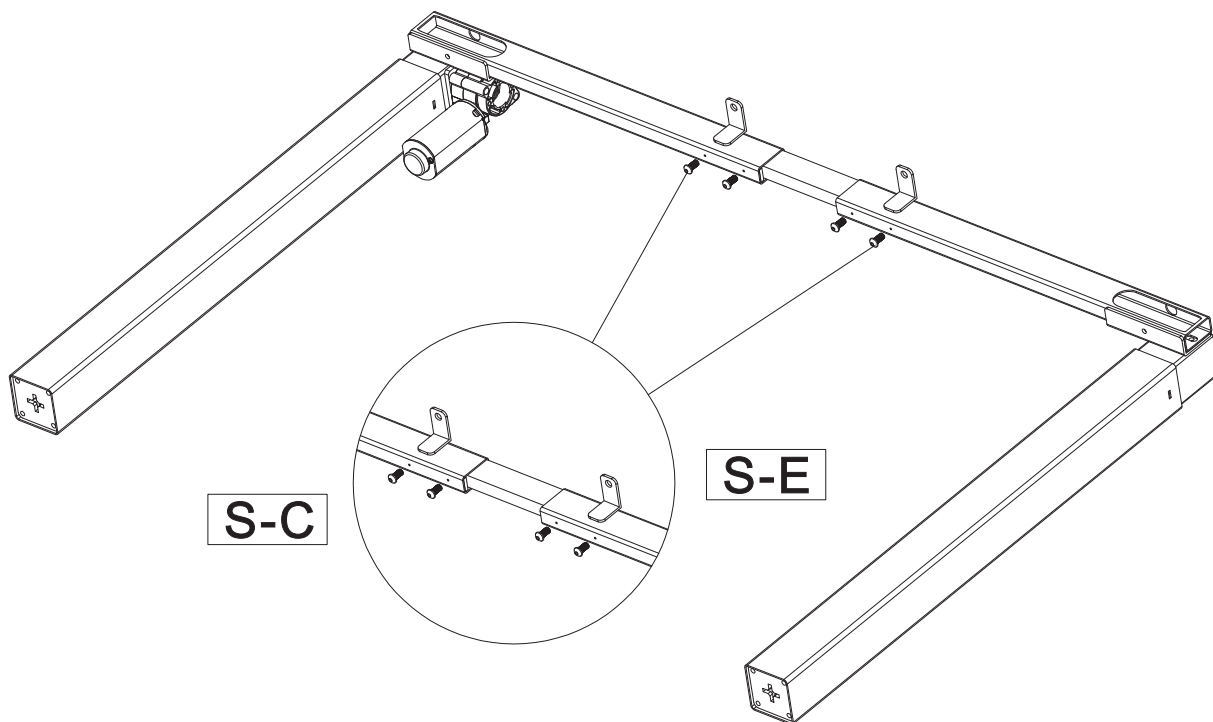
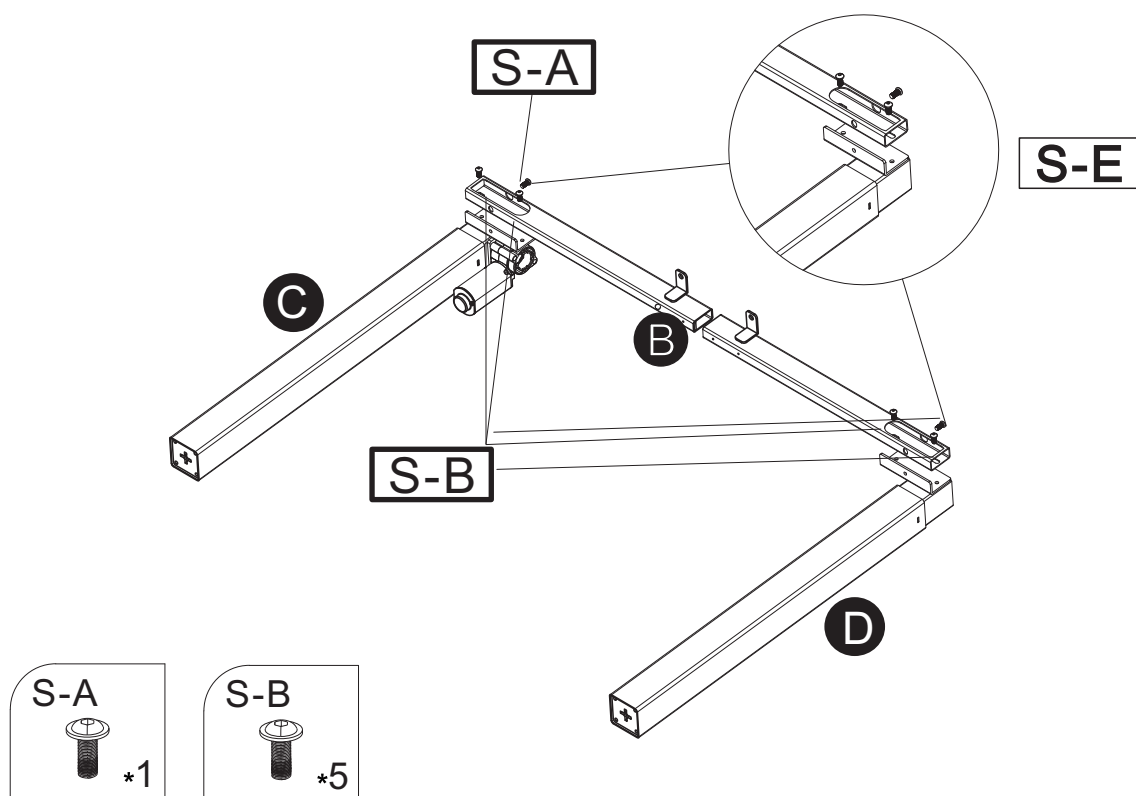

STEP2: Attaching the Feet

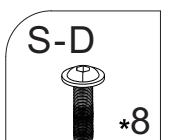
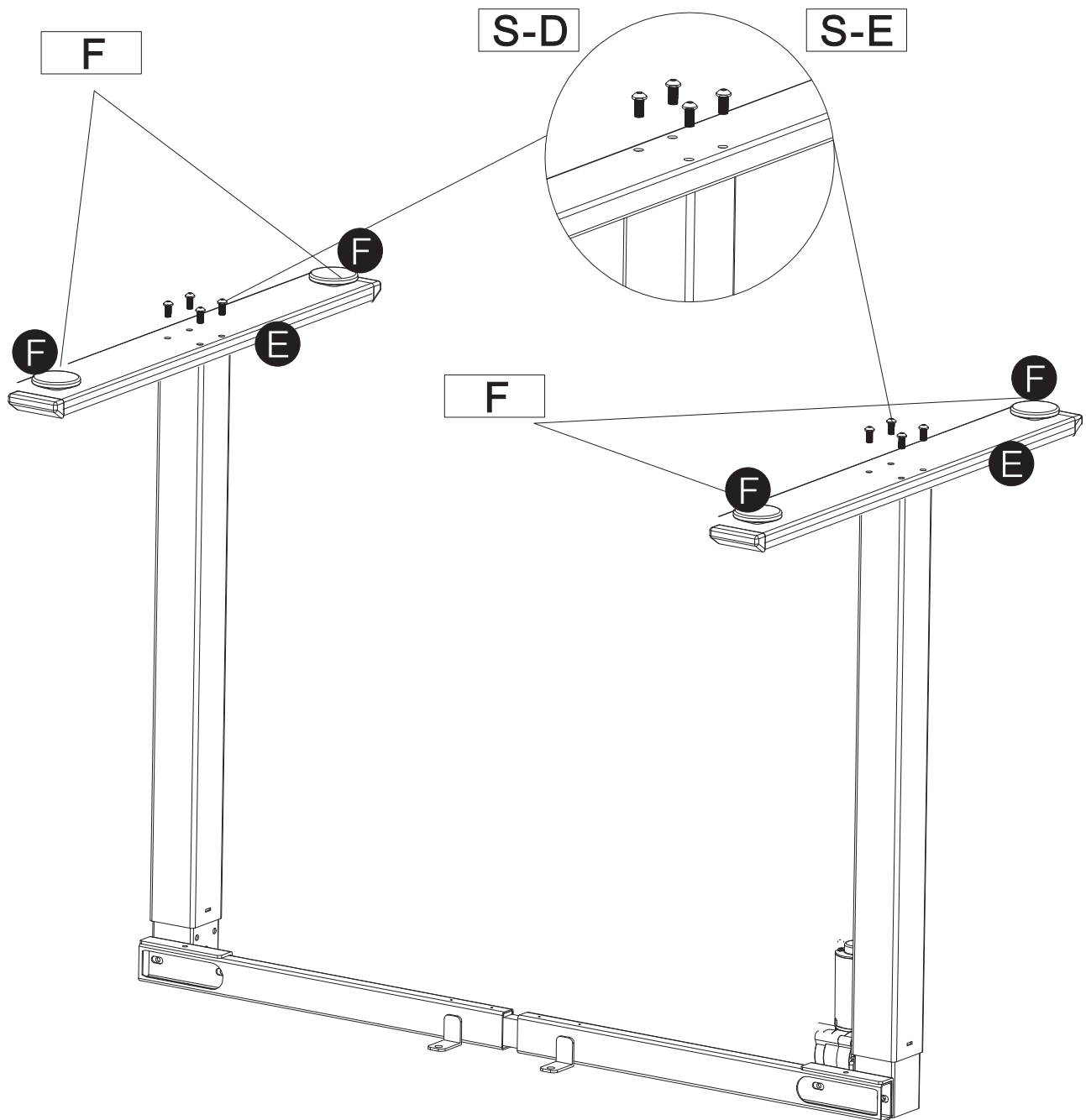

STEP3: Attaching the Side Brackets

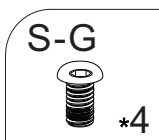
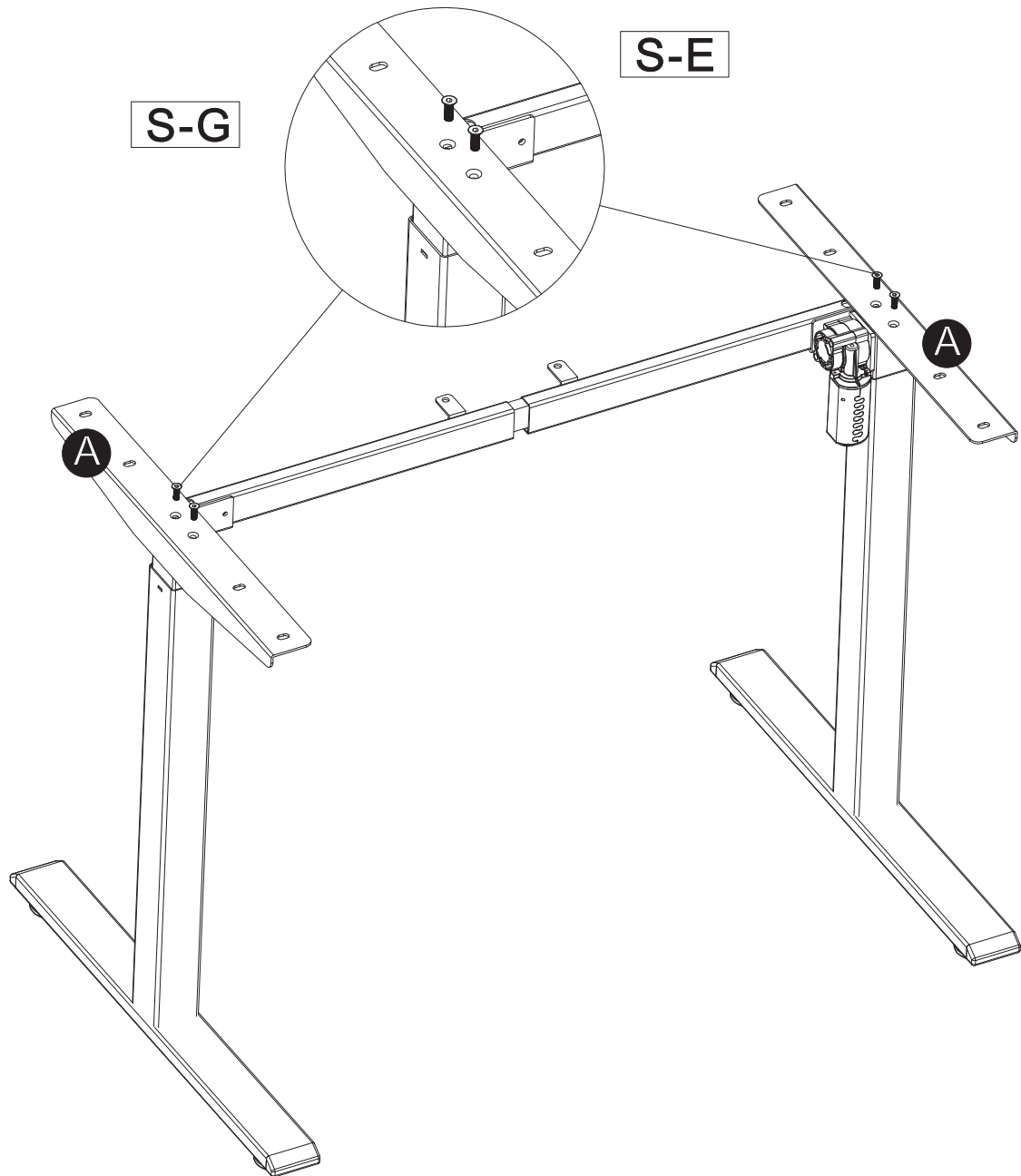

STEP4: Attaching the Sync Rod

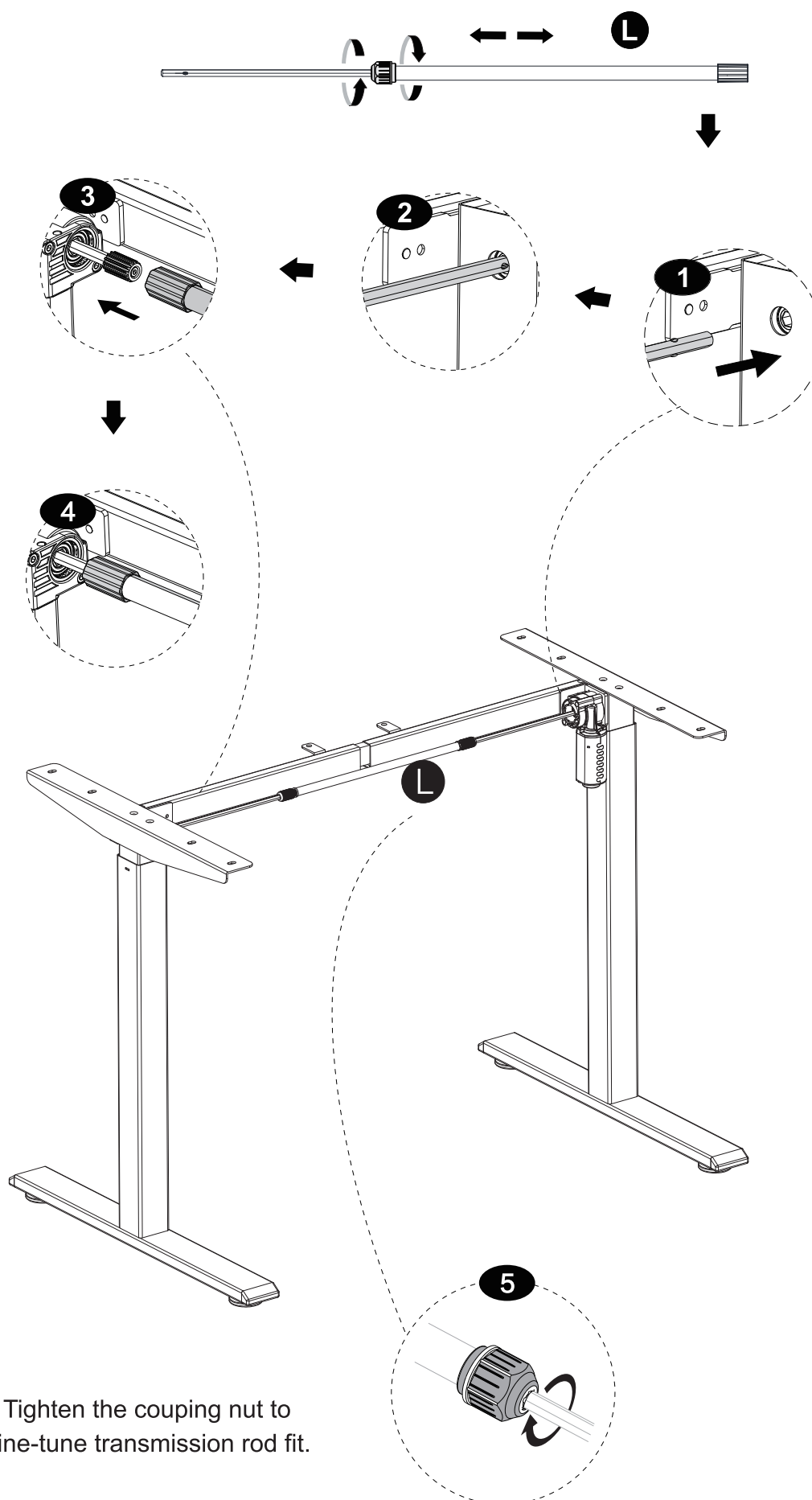

STEP6: Attaching the desktop

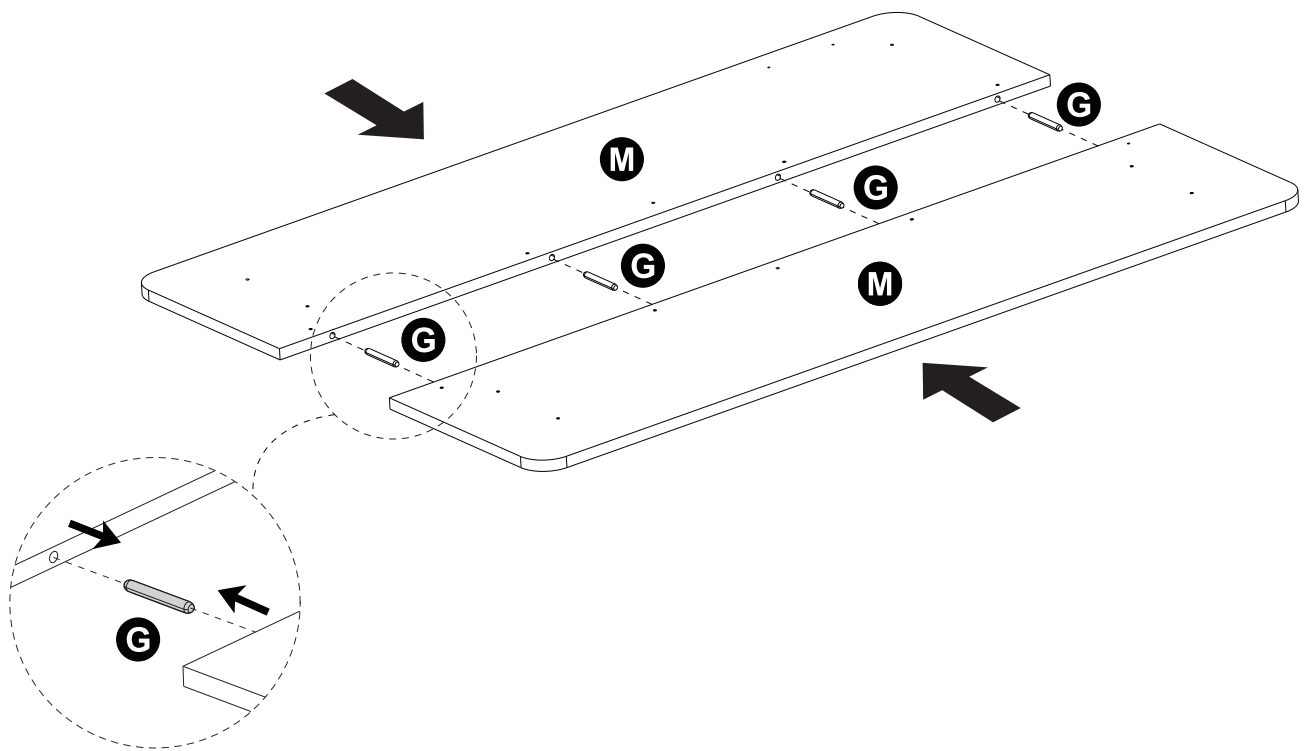

STEP7 Drilling to the deskop

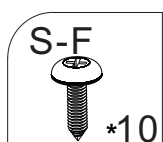
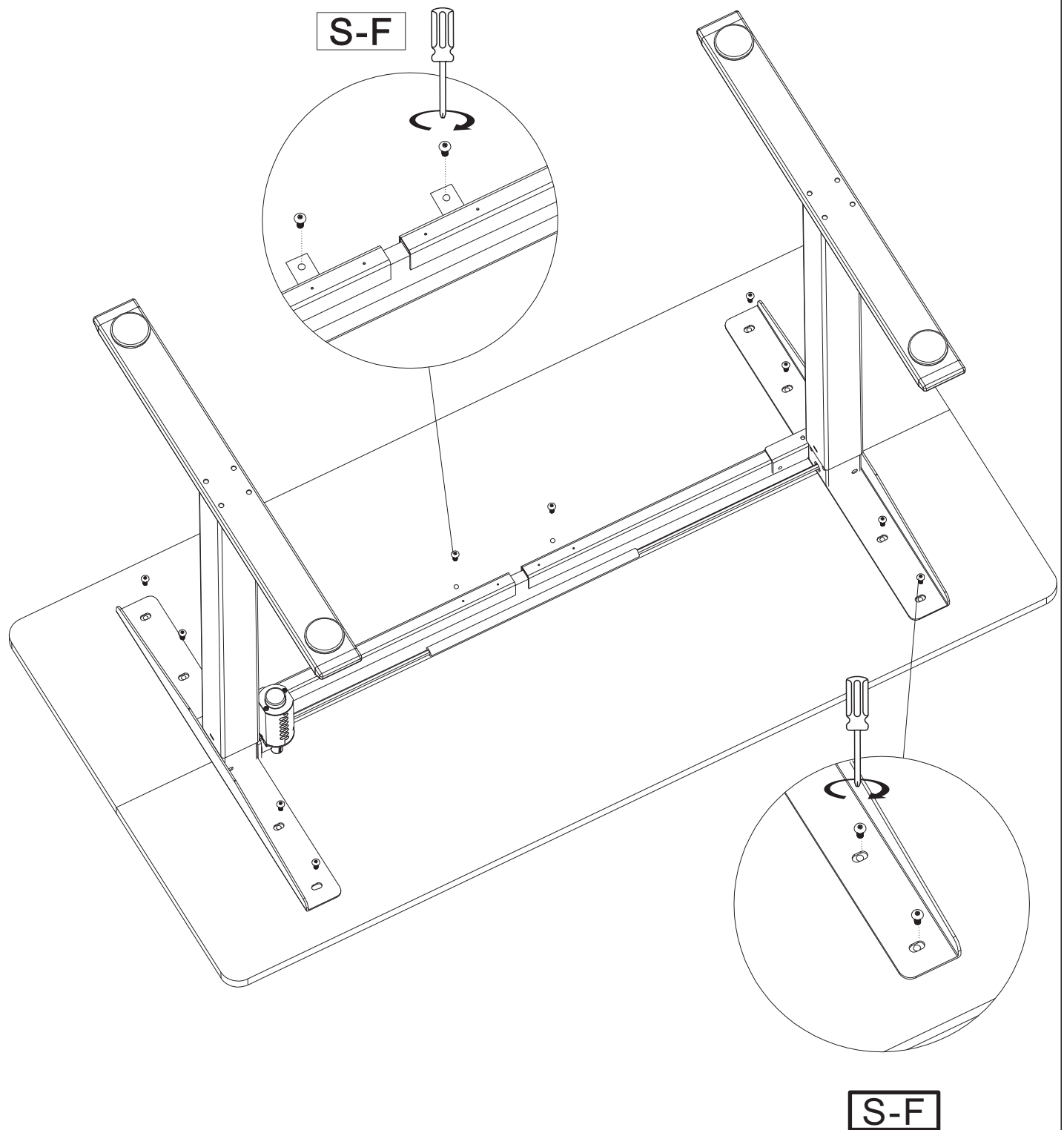

STEP8: Attaching the controller

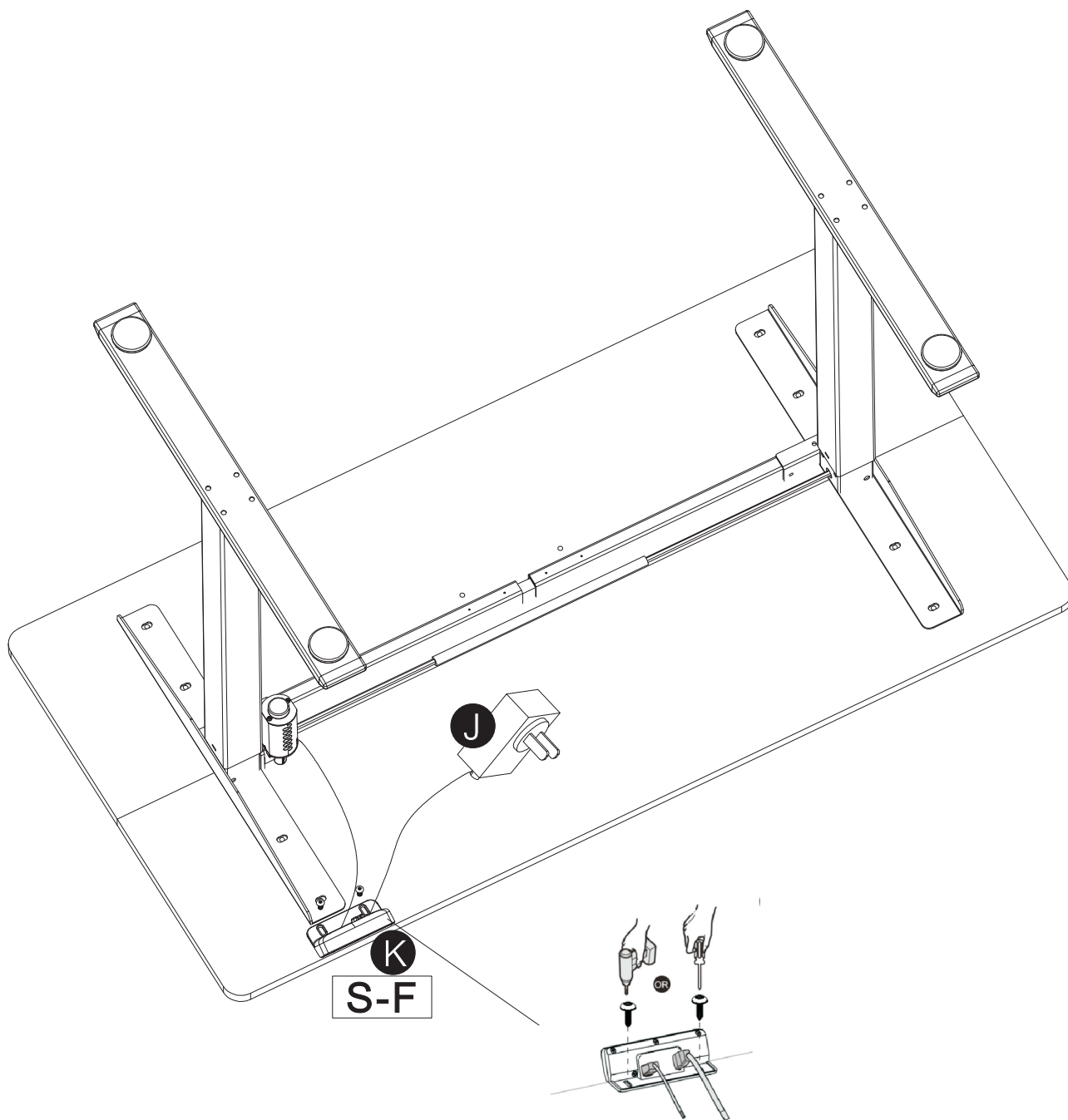

Mounted on the side near the motor

IMPORTANT NOTE:

PLEASE ENSURE THAT ALL ELECTRICAL CORDS AND CABLES ARE CLEAR OF THE FRAME AND MECHANISM.
FAILURE TO DO SO MAY SEVER YOUR POWER CORD RESULTING IN SERIOUS INJURY OR DEATH.

SAFETY NOTE:

WARNING! AVOID POTENTIAL EQUIPMENT DAMAGE OR ELECTRIC SHOCK!
MAKE SURE THE PLUG IS CONNECTED PROPERLY TO THE POWER SOCKET.
KEEP THE PLUG IN AN OPEN, WELL-VENTILATED AREA FREE FROM FOREIGN MATERIAL/DEBRIS TO ENSURE PROPER OPERATION.

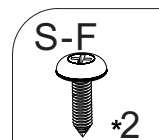

EN

Digital Control Panel For Electric Height Adjustable Desk

User Guide

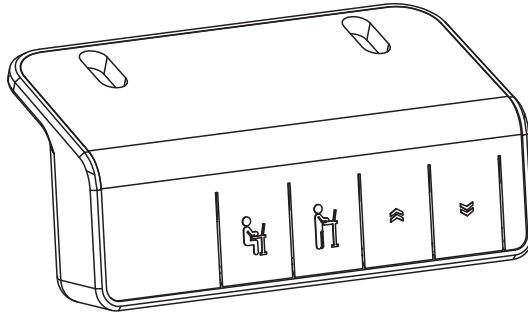

- **Raise the Desk**

Press the  button to raise the desk continuously until it reaches the highest position or the button is released.

- **Lower the Desk**

Press the  button to lower the desk continuously until it reaches the lowest position or the button is released.

- **Select Height Setting 1**

Press the  button, and the desk will move to the height that was previously set for that button.

- **Select Height Setting 2**

Press the  button, and the desk will move to the height that was previously set for that button.



Save Current Height Setting

Settings

- **Reset**

Press and hold the  button until 'rst' is displayed. Continue holding until the desk goes down to its lowest level and comes back up slightly. Release the button, and reset is complete. If the button is released during the reset procedure, reset will stop. The desk won't work until reset is done correctly.

- **Child Lock**

Press and hold the  and  buttons together for 5 seconds to turn child lock on. The screen will show 'LOC' and the buttons will be disabled. Turn child lock off the same way.

- **Power-Saving Mode**

The screen will turn off if there is no button-press for a minute. Any button-press will turn the screen on again.

Protection Mode Error Codes	
SC1	Power Supply Overvoltage Protection: Input voltage too high. If the correct AC adapter is being used, power off the desk, check the connection between power and the controller, and power on again. If error code persists, please contact technical support.
hot	Overheating Protection: When the motor has been working continuously for too long, it will stop operating to prevent overheating. Wait for at least 18 minutes (until error code disappears) before making any further height adjustment.
r-6	Power Supply Overvoltage Protection (during use): Input voltage too high. Error clears when power supply voltage returns to normal. If error code persists, please contact technical support.
rst	Reset Warning: Continue to complete reset.
E 11	Overloading Protection: Max load exceeded. Error code will persist for 20 seconds (DO NOT operate). Take the things off the desk and confirm there is no mechanical damage before trying again.

rst	Reset Warning: Continue to complete reset.
EX0	Short Circuit Protection: Power off, check the cable connections, and power back on again. If error persists, please contact technical support.
EX1	Overloading Protection: Max load exceeded. Error code will persist for 20 seconds (DO NOT operate). Take the things off the desk and confirm there is no mechanical damage before trying again.
EX2	Motor Phase Error Protection: Power off, check the cable connection between the motor and the controller, and power back on again. Then follow the reset instructions. If error code persists, please contact technical support.
EX3	Sensor Malfunction Warning: Motor sensor can't be detected. Power off, check the cable connection between the motor and the controller, and power back on again. Then follow the reset instructions. If error code persists, please contact technical support.
EX4	Anti-Collision System Warning: Impact detected. The desk will move 2" (50mm) in the opposite direction and stop.
EX6	Cable Disconnection Warning: Check motor and controller cable connections. Normal operation should return once all connectors are properly connected. If error code persists, please contact technical support.
EX7	Mechanical Failure Warning: Check if there is any structural damage or motor fault.

Note: "X" represents the table leg number product 1, 2, 3.....

CARE AND MAINTENANCE

REGULAR CARE:

To protect your furniture, we suggest the following:

- Avoid placing your furniture in direct sunlight.
- Do not place furniture directly under windows.
- Do not place sharp materials (knife, fork, etc.) directly onto your furniture as sharp material may scrape and damage the finish.
- Do not place material with high temperature directly onto the surface of your furniture.
- Clean up spills quickly. Water left over a prolonged period of time may cause damage. Alcohol, perfume, nail polishes, aftershave and some medication may cause severe finish damage if not cleaned immediately.
- Use a clean, soft, dry, lint free absorbent cloth to clean your furniture. Do not use any detergent as they may contain ingredients that may react and damage the finish.

NOTE: If the above care advise is not adhered to your product warranty may become void.

CLEANING:

- Do not rub.
- Do not spot clean with any solvent.
- Treat spills and stains as soon as possible.
- Gently scrape off any soil or blot any liquid from the surface before applying cleaner.
- Apply proprietary cleaning agents strictly according to instructions to remove the residue of the spill.

Safety Note:

Warning! Avoid potential equipment damage or electric shock!

Warning! Do not cover the transformer. Keep the transformer in an open, well-ventilated area free from foreign material/debris to ensure proper operation.

• Do not:

- Use this product as a step stool or ladder.
- Failure to follow this warning could result in injury.